



APOLLO

A636 APARTMENT COMPACTOR

**DESIGNED FOR LARGER
36" DIAMETER CHUTES**

FEATURES INCLUDE:

- 30" x 36" CHARGING CHAMBER
- 1/4" INTEGRAL MAINFRAME / HOPPER DESIGN
- 3/8" A.R. FLOOR PLATE FOR LONGER LIFE
- SINGLE SIDE LATCH OPTION
- DUAL 3" x 2" CYLINDERS
- SINGLE PIECE RAM
- 80% & 100% FULL LIGHTS WITH AUTOMATIC SHUTDOWN
- KEY ON/OFF
AUTOMATIC PHOTO SENSOR OPERATION
MANUAL FORWARD / REVERSE
EMERGENCY STOP BUTTON
POWER ON LIGHT
- MICROPROCESSOR CONTROLS WITH EASY READ OUT FOR PROGRAMMING AND TROUBLESHOOTING
- UL LISTED POWER PACK
FACTORY ASSEMBLED

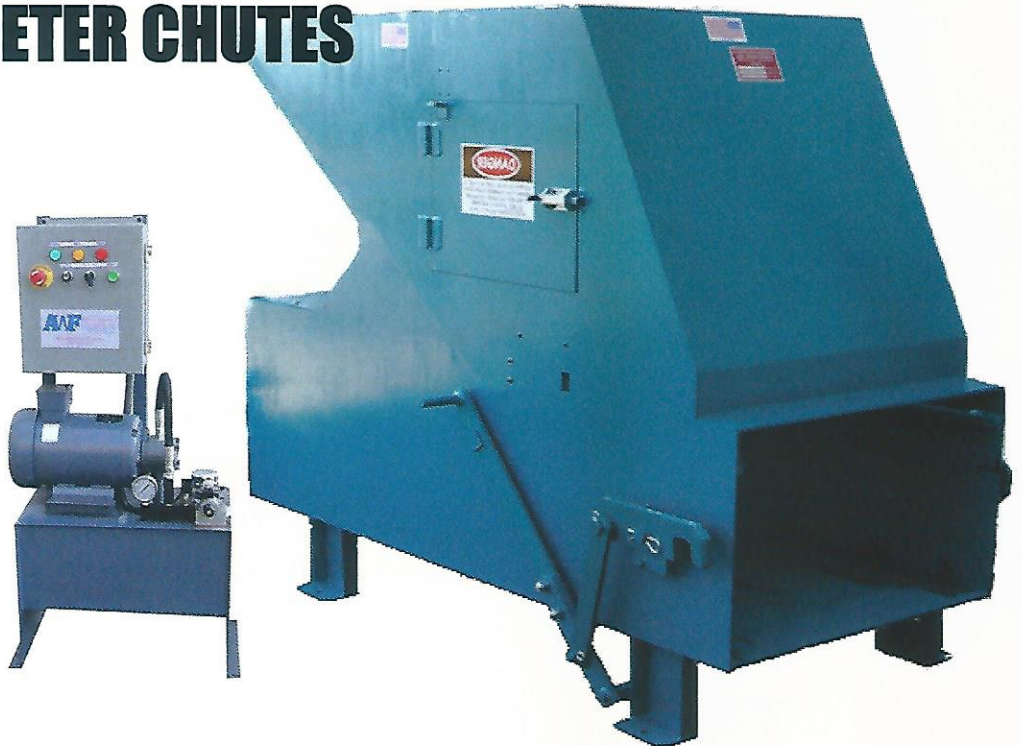

**STANDARD 72" LONG
COMPACTOR**

**OVERSIZED 30" x 36"
COMPACTION CHAMBER**

PRODUCT DATA AND RATINGS A636

GENERAL

COMPACTOR MODEL	APOLLO A636
CHAMBER CAPACITY - MFR	0.52 CU.YDS
CHAMBER CAPACITY - WASTEC	0.44 CU.YDS
CHAMBER CLEAR TOP OPENING	31" L x 35.5" W
TOP OPENING	54"L x 35.5"W
RAM DIMENSIONS	18"H x 30.5"W
OVERALL DIMENSIONS	72"L x 41"W x 69"H
EST. SHIPPING WT.(INCL. POWER PACK)	2000 LBS

PERFORMANCE CHARACTERISTICS

CYCLE TIME	37 SECS.
CAPACITY PER HOUR	51 CU.YDS.
RAM FACE PRESSURE (N) @ 1600 PSI	36 PSI
RAM FACE PRESSURE (M) @ 1800 PSI	40 PSI
PACKING FORCE (N) @ 1600 PSI	22,500 LBS
PACKING FORCE (M) @ 1800 PSI	25,500 LBS

STRUCTURAL CHARACTERISTICS

MAIN FRAME & HOPPER	1/4" HRS PLATE
IMPACT PLATE - REINFORCED	1/4" HRS PLATE
FLOOR PLATE	3/8" A.R.PLATE
RAM FACE PLATE	3/8" HRS PLATE

ELECTRICAL SPECIFICATIONS

REMOTE POWER PACK DIMENSIONS	46"H x 22"W x 14"D
MOTOR	5HP
MOTOR POWER	208/230/460V, 3PH, 30 AMPS
CONTROL VOLTAGE	120VAC (24VDC OPTION)
CIRCUITS CONTROLLER	PLC PROCESSOR
MONITORS	80% & 100% FULL
PHOTO ELECTRIC EYE	OMRON E3K
DOOR SAFETY SWITCH	TELEMECANIQUE
CONTROL PANEL	UL LISTED

HYDRAULIC SPECIFICATIONS

CYLINDERS	3" BORE, 2" ROD
HYDRAULIC PUMP CAPACITY	6 GPM
OIL TANK CAPACITY	12 GALS.
OPERATING PRESSURE	1600 PSI
RELIEF PRESSURE	1800 PSI
MAXIMUM RATED PRESSURE	3000 PSI

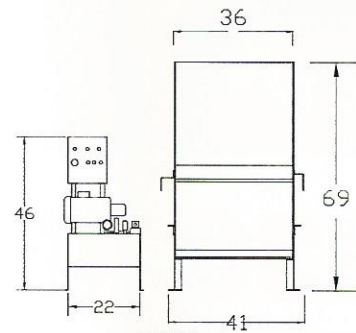

FRONT

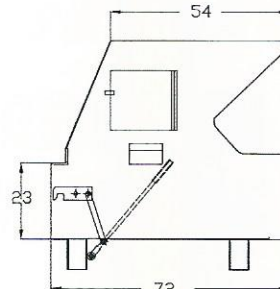

SIDE

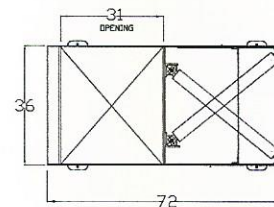

TOP SECTIONAL VIEW

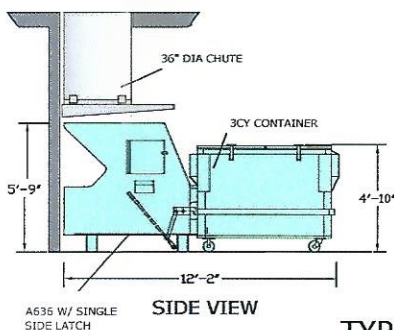

A636 W/ SINGLE SIDE LATCH
SIDE VIEW

TYPICAL LAYOUT
A636

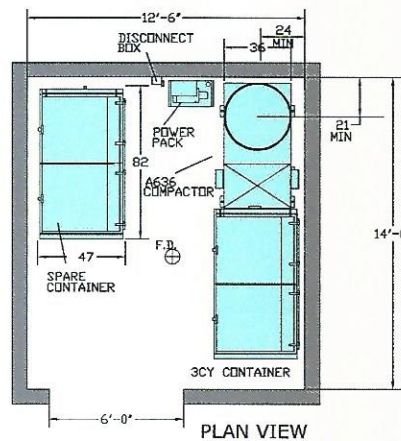

PLAN VIEW

APOLLO WELDING AND FABRICATING, INC.

35600 CURTIS BLVD, EASTLAKE, OHIO 44095

PH: 440 942 0227 FAX: 440 942 0127

apollo@apollowelding.com

www.apollowelding.com

DISTRIBUTED BY: