



APOLLO

A500-N APARTMENT COMPACTOR

FEATURES INCLUDE:

- 1/4" INTEGRAL MAINFRAME / HOPPER DESIGN
- 3/8" A.R. FLOOR PLATE FOR LONGER LIFE
- SINGLE SIDE LATCH OPTION
- DUAL 3" BORE X 2" ROD CYLINDERS
- 80% AND 100% FULL LIGHTS WITH AUTOMATIC SHUTDOWN
- KEY ON/OFF PHOTO EYE OPERATION MANUAL FOR/REV EMERGENCY STOP POWER ON LIGHT
- MICROPROCESSOR CONTROLS WITH EASY READ OUT FOR PROGRAMMING AND TROUBLESHOOTING.
- UL LISTED CONTROL PANEL



NARROW 60 INCH LONG COMPACTOR TO SUIT THOSE TIGHT AREAS WHERE A STANDARD 72 INCH COMPACTOR IS NOT SUITABLE.

PRODUCT DATA AND RATINGS

GENERAL

COMPACTOR MODEL	APOLLO A500-N
CHAMBER CAPACITY - MFR	0.28 CU.YDS.
CHAMBER CAPACITY - WASTEC	0.23 CU.YDS.
CHAMBER CLEAR TOP OPENING	24" x 30"
TOP OPENING	42" x 30"
RAM DIMENSIONS	18" x 25.5"
OVERALL DIMENSIONS	60"L x 31"W x 67.5"H
EST. SHIPPING WT. (INCL.POWER PACK)	1700 LBS

PERFORMANCE CHARACTERISTICS

CYCLE TIME	26 SECS
CAPACITY PER HOUR	42 CU.YDS
RAM PENETRATION	7"
RAM FACE PRESSURE (N) @ 1600 PSI	41 PSI
RAM FACE PRESSURE (M) @ 1800 PSI	46.5 PSI
PACKING FORCE (N) @ 1600 PSI	22,500 LBS
PACKING FORCE (M) @ 1800 PSI	25,500 LBS

STRUCTURAL CHARACTERISTICS

MAIN FRAME AND HOPPER	1/4" PLATE
IMPACT PLATE	1/4" PLATE
FLOOR PLATE	3/8" AR PLATE
RAM FACE PLATE	3/8" PLATE

ELECTRICAL SPECIFICATIONS

REMOTE POWER PACK DIMENSIONS	46"H x 22"W x 14"D
MOTOR	5HP
MOTOR POWER	208/230/460V, 3PH, 30 AMPS
CONTROL VOLTAGE	120VAC (24VDC OPTION)
CIRCUITS CONTROLLER	ZELIO PLC PROCESSOR
MONITORS	80% & 100% FULL
PHOTO ELECTRIC EYE	OMRON E3K
DOOR SAFETY SWITCH	TELEMECANIQUE
CONTROL PANEL	UL LISTED

HYDRAULIC SPECIFICATIONS

CYLINDERS	DUAL 3" BORE, 2" ROD
HYDRAULIC PUMP CAPACITY	6 GPM
OIL TANK CAPACITY	12 GALS.
OPERATING PRESSURE	1600 PSI
RELIEF PRESSURE	1800 PSI
MAXIMUM RATED PRESSURE	3000 PSI

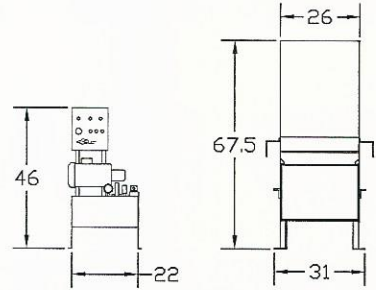

FRONT

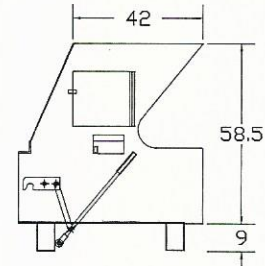

SIDE

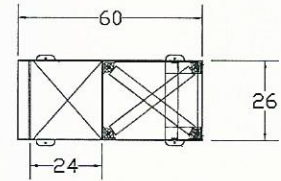

PLAN

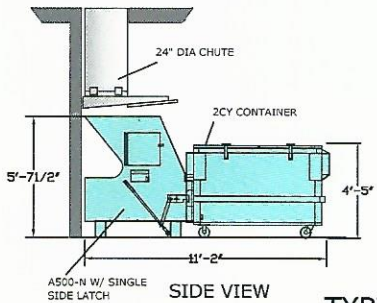

SIDE VIEW

TYPICAL LAYOUT
A500-N

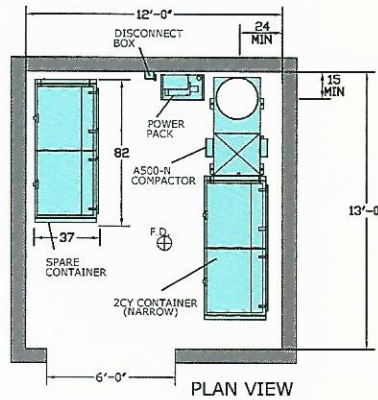

PLAN VIEW

APOLLO WELDING AND FABRICATING, INC.

35600 CURTIS BLVD, EASTLAKE, OHIO 44095

PH: 440 942 0227

FAX: 440 942 0127

apollo@apollowelding.com

www.apollowelding.com

DISTRIBUTED BY: